

385_{kg}
Weight Capacity

Up To
10.16_{cm}
Maximum Height

Slip Resistant
Easy-to-Install & Maintenance Free



Made from high-impact recycled rubber

Rubber Threshold Ramps from Pride Mobility® provide a safe, durable means of navigating uneven household surfaces, including small steps and doorways. A hidden dovetail locking system allows for easy installation and incremental ramp height adjustment of up to 10.16 cm (4"). A modular design makes our Rubber Threshold Ramps a practical and affordable home accessibility solution.

Specifications

Rise	Total Length	Usable Width	Overall Width	Total Weight
2.5 cm (1")	26.5 cm (10.43")	91.4 cm (36")	99.1 cm (39")	4.3 kg (9.5lbs.)
3.8 cm (1.5")	44 cm (17.33")	91.4 cm (36")	104.1 cm (41")	9.75 kg (21.5lbs.)
5.1 cm (2")	61.5 cm (24.23")	91.4 cm (36")	108 cm (42.5")	16.8 kg (37lbs.)
6.4 cm (2.5")	79 cm (31.13")	91.4 cm (36")	112.3 cm (44.2")	25 kg (55lbs.)
7.6 cm (3")	98.1 cm (38.63")	91.4 cm (36")	116.8 cm (46")	35.4 kg (78lbs.)
8.89 cm (3.5")	115.6 cm (45.5")	91.4 cm (36")	118 cm (46.5")	46.9 kg (18.5")
10.16 cm (4")	133.1 cm (52.4")	91.4 cm (36")	118 cm (46.5")	59.96 kg (23.6")

The Rubber Threshold Ramp has a maximum incline of 4° (7%).

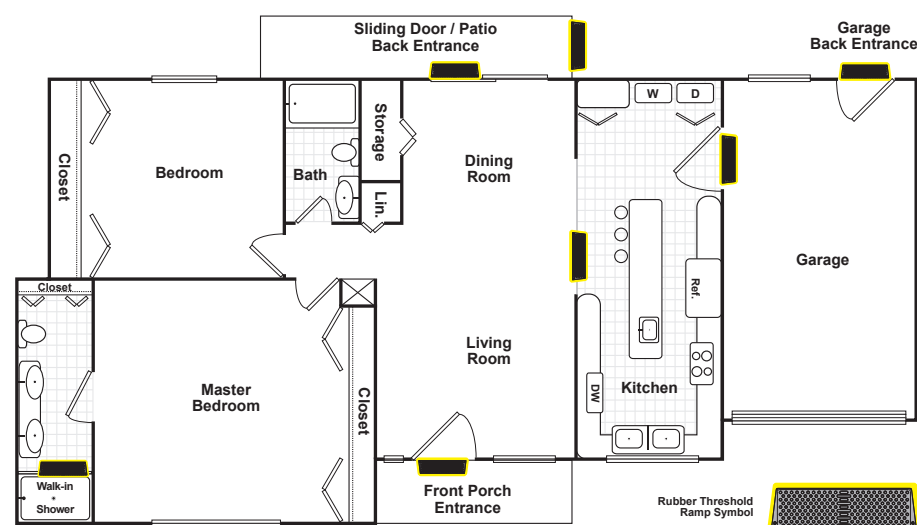
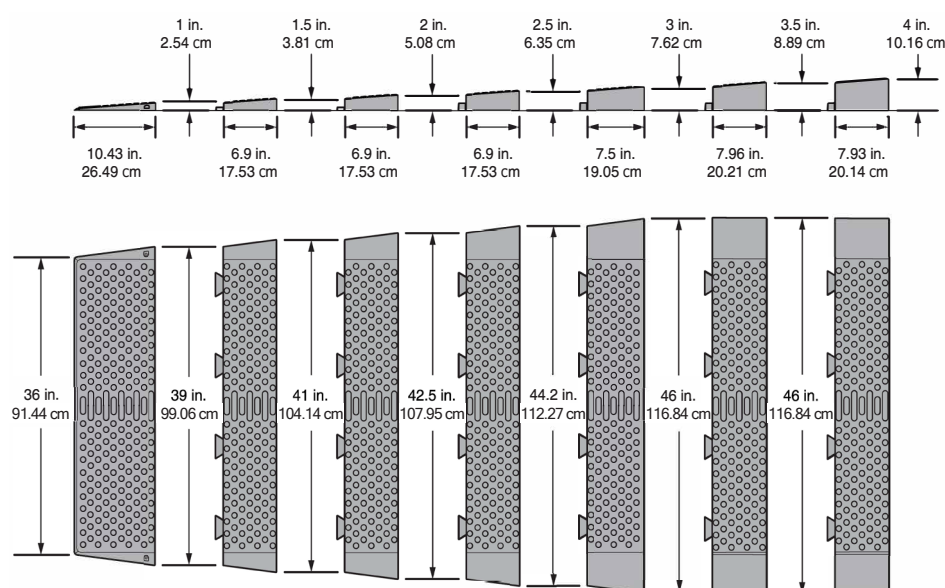

Features

- Constructed of high-impact recycled rubber for durability and long-life
- Seven total pieces:
 - Increased by 2.5 cm (1")
 - Height increments from 2.5 cm (1") to 10.16 cm (4") at maximum height
 - 91.4 cm (36") of usable space
- Can be used indoors or outdoors
- Slip resistant
- Easy-to-install
- Maintenance-free
- 385.5 kg (850 lbs.) weight capacity
- Can be trimmed or notched for a custom fit



Interlocking System

Applications

Rubber Threshold Ramps can be used indoors and outdoors in a variety of locations, whether it's in your home, the office or the garden. Uses in home may include:

- At front and back entrance doors
- Changes in the floor level throughout the house eg:
 - Garage to kitchen, kitchen to living room and walk-in showers.

Caution: This product is made from recycled natural rubber which may contain Latex and could cause an allergic reaction in some individuals.

The information contained herein is correct at the time of publication; we reserve the right to alter specifications without prior notice.